



Accessible Space, Inc.

2550 University Avenue West, Suite 330 N | St. Paul, Minnesota 55114

OUR MISSION HOUSING WITH CARE

The mission of Accessible Space, Inc. (ASI) is to provide accessible, affordable, assisted/supportive and independent living opportunities for persons with physical disabilities and brain injuries, as well as seniors. This mission is accomplished through the development and cost-effective management of accessible, affordable housing, as well as the provision of assisted/supportive living and rehabilitation services.

ACKNOWLEDGEMENTS FUNDING AND SUPPORT

Accessible Space, Inc. (ASI) gratefully acknowledges the following organizations for their funding and/or support:

The U.S. Department of Housing and Urban Development (HUD); Alexandria Housing and Redevelopment Authority; Federal Home Loan Bank of Des Moines' Affordable Housing Program/U.S. Bank; and The Otto Bremer Foundation



Committed to the success of equal housing opportunities throughout the nation

ASI

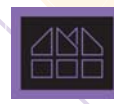

Accessible Space, Inc. (ASI):
Sponsor, Developer and
Management Agent

NORDIC MEADOW APARTMENTS ALEXANDRIA, MINNESOTA



***Accessible, Affordable Apartments For
Adults With Qualifying Disabilities***

410 34th Avenue East
Alexandria, Minnesota 56308



Accessible Space, Inc.

HOUSING WITH CARE

NORDIC MEADOW ALEXANDRIA, MINNESOTA

Accessible, Affordable Apartments For Adults With Qualifying Disabilities

AFFORDABLE

- Qualifying households pay 30% of adjusted gross monthly income for rent
- Rent is subsidized by the U.S. Department of Housing and Urban Development (HUD)-Income limits apply
- Rent includes: Heat, water, sewer, trash & snow removal

BASIC QUALIFICATIONS

- One household member must have a qualifying disability
- Applicants are screened for credit, rental and criminal history
- Households must be income qualified (income limits apply and security deposit required)

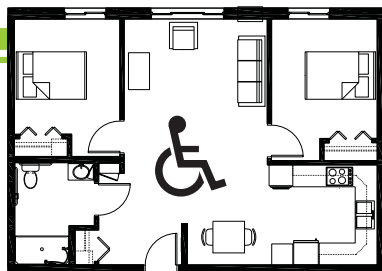

APARTMENT FEATURES

- 15 accessible, one and two bedroom apartments
- Wheelchair accessible, spacious kitchen
- Large, accessible bathroom with roll-in shower
- Generous closet & storage space
- Carpeted bedroom & living room

BUILDING FEATURES

- Large, open entry & lobby
- Controlled access entry system
- Outdoor patio with gas grill
- On-site laundry facilities
- Elevator service
- Approved pets welcome!
- Exercise room



CONVENIENT NEIGHBORHOOD LOCATION

- Grocery stores, shopping & restaurants
- Banking Services
- Hospitals, medical & professional clinics
- Churches

For more information or to request a housing application, please call

- toll-free 1-800-466-7722
- tty/tdd 1-800-627-3529

Apply online www.accessiblespace.org

Accessible Space, Inc. (ASI)

2550 University Avenue West, Suite 330 North
Saint Paul, Minnesota 55114

